

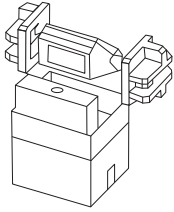

1 Remove the 740SELECT monitor and the accessory box from the shipping carton



1. Remove the plastic bag and monitor screen protector
2. Place the 740SELECT monitor and accessory box on a secure tabletop
3. The 740SELECT is shipped with the Li-ion battery installed

2 Open the 740 SELECT standard accessory box and review contents

1. Identify the monitor part number located on the (monitor) rear label
2. Verify packout table below

Part Number	NIBP	SpO ₂	Temp	ECG	Standard
01-02-1000	✓				✓
01-02-1001	✓	✓			✓
01-02-1002	✓	✓			✓
01-02-1003	✓	✓	✓		✓
01-02-1004	✓	✓	✓		✓
01-02-1009	✓		✓		✓
01-02-1013		✓	✓		✓
01-02-1014		✓	✓		✓
01-02-1015		✓			✓
01-02-1016		✓			✓
01-02-1018	✓	✓		✓	✓
01-02-1019	✓	✓		✓	✓

Part Number	NIBP	SpO ₂	Temp	ECG	Standard
01-02-1020	✓	✓	✓	✓	✓
01-02-1021	✓	✓	✓	✓	✓
01-02-1024		✓		✓	✓
01-02-1025		✓		✓	✓
01-02-1026		✓	✓	✓	✓
01-02-1027		✓	✓	✓	✓

Pack-Out Description

NIBP BP start-up kit	Temp • FILAC 3000 isolation chamber • FILAC temperature probe • 1 box of temperature probe covers	ECG • ECG lead set • ECG trunk cable	Standard • Power supply • Power cord • User manual, addendums, and field service manual on CD • Quick reference guide (monitor operation)
--------------------------------	---	---	--

3 The following accessory item(s) may be placed in the monitor pack-out if purchased with the monitor

- | | |
|--|---|
| Masimo® CO₂
• ISA™ CO ₂ start-up kit
• IRMA™ CO ₂ start-up kit | CO₂ Analyzer Accessory
• ISA CO ₂ holster
• ISA CO ₂ clamp adapter
• ISA CO ₂ module holder |
|--|---|

Note: The Microstream® Micropod™ start-up kit, cradle and clip (or cradle and VESA mount) are packaged separate from the monitor.

4 The SpO₂ connector (left-hand side) and monitor input panel are keyed to assure proper orientation.

1. Align the SpO₂ connector and push into the input panel until the connection is seated.
The connector is properly seated when you hear a click.
2. Complete the cable connection to the SpO₂ patient sensor.

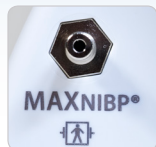

Male NIBP Connector



NIBP hose connection CASMED MAXNIBP

1. Remove the BP hose from the BP Start Up Kit.
2. Align the female NIBP hose connector and push onto the male connector.
You will hear a “click” when the connection is properly seated.
3. Gently pull on the BP hose to verify proper connection.
Movement between the BP hose and connector is normal. The connection is designed to allow the hose to move slightly in and out and rotate while maintaining a secure connection.
4. Pull the metal ring to release the hose from the NIBP connector.

5 Assemble Covidien™ FILAC 3000 Temperature probe and chamber / 740SELECT models with temperature

1. Locate the FILAC 3000 Temperature probe (L-shaped connector).

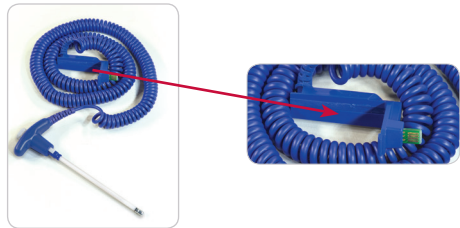

2. Position the isolation chamber as shown.

3. Align the top of the temperature probe L-shaped connector to the slot.

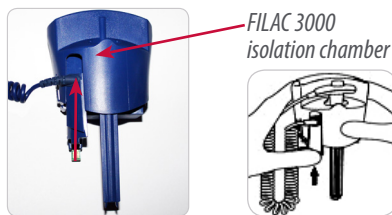

4. Slide the connector up and into the slot until fully seated (you will hear a click).

5. Insert the temperature probe into the temperature probe well as shown.

6 Insert isolation chamber (and probe) into side car / 740SELECT models with temperature

Isolation chamber

Temperature side car

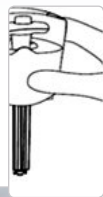

1. Insert the assembled probe and isolation chamber into the temperature side car.
2. Align the probe well and slide into the side car.

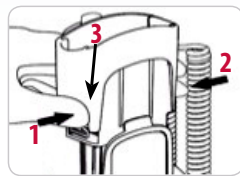

3. Three alignment tabs should be engaged and seated into the side car (1, 2, 3).

4. Push the isolation chamber down into the side car until you hear a click.



Well for temperature probe
Isolation chamber

5. Verify that the isolation chamber is fully seated all around.

7 Insert temperature probe covers into isolation chamber / 740SELECT models with temperature

Arrow icon on probe box



1. Position the probe covers with the temperature probe access cover opening toward the front of the monitor.

2. Insert the box of probe covers into the slot until you hear a click.

8 Connect the 740SELECT power supply and power cord

Power cord connected to power supply

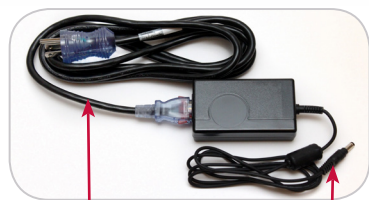

Power cord

Barrel connector

1. Connect the power cord to the power supply by fully inserting into the power supply.

2. Connect the barrel connector to the monitor.

3. Connect the power cord plug to a wall outlet.



9 Turn the 740SELECT monitor on



1. Press the On/Off power button located on the front panel to turn the monitor on.

- The On/Off switch illuminates when the monitor is turned on.
- During boot-up a configuration setup test and POST is performed automatically (20-25 seconds).
- Completion of the test and POST is confirmed by a two beep audio alert.

2. Verify the monitor battery charging LED is lit (when plugged into wall outlet).

- Recommend fully charging battery before entering into service.
- Reference 740SELECT user manual for operating instructions.